

Ergonomic Workspace Solutions

redefining **YOUR WORKSPACE**

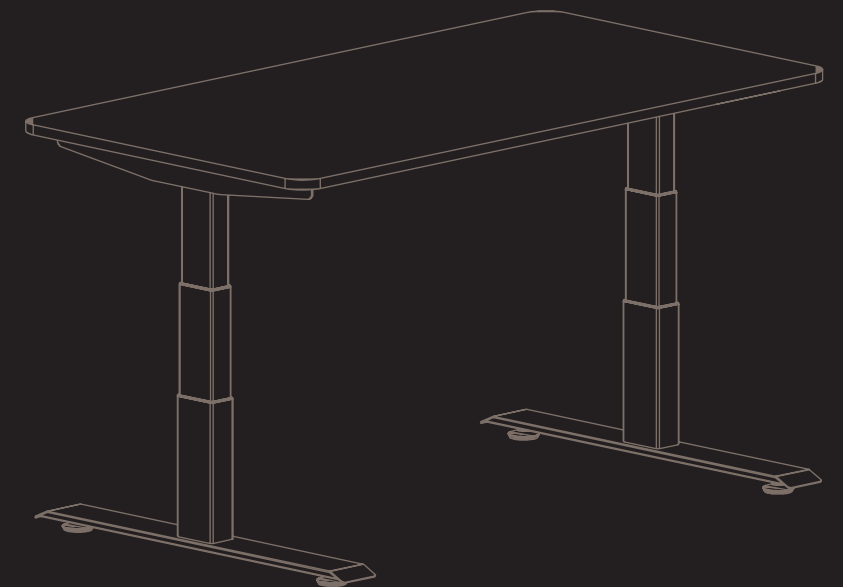

Livcommerce Co.,Ltd.

172-174 Na Muang Rd.,Nai Mueang Subdistrict, Mueang Khon Kaen District, Khon Kaen Province, Thailand



Tel: +66 92 287 5355
Email: alpha@livth.com
Line: @livth
www.livdesk.com



CONTENTS

CATALOGUE

1 **BRAND STORY & BRAND STRATEGY**

3 **ABOUT BRAND**

5 **CUSTOMIZATION POSSIBILITIES**

7 **INNOVATIVE INTELLIGENCE**

9 **FRAME COLLECTIONS**

NEW PRODUCT SERIES - P09
1-LEG SERIES- P11
2-LEGS SERIES - P13
3-LEGS SERIES - P19
4-LEGS SERIES - P23
ECONOMICAL SERIES - P27
MANUAL SERIES - P29
HOME OFFICE SERIES - P31

35 **MODULE**

P35 - LIFT COLUMNS
P37 - HANDSETS
P39 - FEET
P40 - CONTROL BOX

41 **SUSTAINABLE DEVELOPMENT**

BRAND STORRY & BRAND STRATEGY

CORE VALUES



OUR STORY

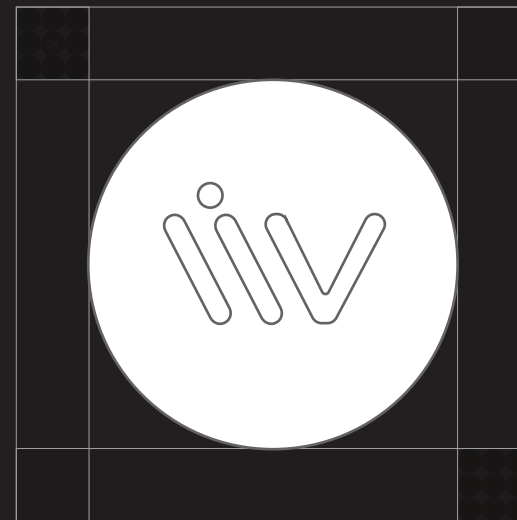

INTELLIGENT DESIGN

Every product we create seamlessly integrates functionality and innovation into your workspace.

SIMPLICITY

We believe in simple and modern design that is not only functional but also enhances the aesthetics of your workspace.

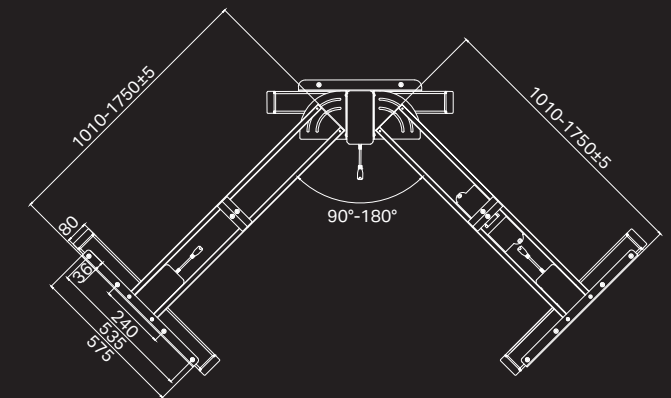

MISSION

VISION

Our vision is a future where work and well-being go hand in hand. We imagine a world where every home office is a space of comfort, health, and productivity. Our goal is to be at the forefront of ergonomic innovation, constantly evolving our products to meet the changing needs of remote professionals. We aspire to reach homes worldwide, making ergonomic well-being not a luxury, but a standard for every working individual.

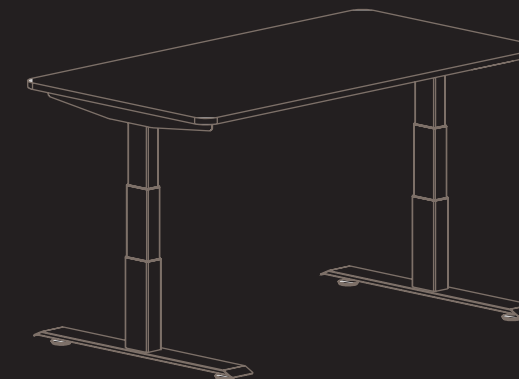

VALUE & QUALITY

Our commitment is to offer top-tier ergonomic products at accessible prices, ensuring that good health and productivity are within everyone's reach.

HEALTH & PRODUCTIVITY

At the core of our mission, we believe that a well-designed workspace is essential for maintaining good health and enhancing work efficiency.

EXCELLENCE THROUGH EXPERTISE



LIV partners with a key member of China's CEESTA standard drafting committee. This gives us direct access to expertise from those who define national standards for height-adjustable desks, ensuring our products exceed industry benchmarks with superior quality and innovation.

UNCOMPROMISING QUALITY, GUARANTEED



At LIV, we obsess over every detail—from research and premium materials to precise production and rigorous testing. This commitment to excellence enables us to offer customers a worry-free warranty on all our products.

MEETING DEMAND WITH PRECISION



At LIV, we work with partners operating a 25,000+ square meter manufacturing facility. Their high efficiency and quality certifications allow us to fulfill multiple orders simultaneously, ensuring on-time delivery even for large-volume demands.

QUALITY CONTROL



At LIV, we elevate manufacturing standards through precise quantifiable quality metrics and rigorous production control. By focusing on problem source identification and implementing comprehensive intelligent systems, we ensure every product consistently meets our exacting standards.

CUSTOMIZATION



At LIV, we leverage partnerships with experienced engineering teams to offer customized innovations for our customers. With access to over 2,000 diverse product designs, we provide solutions that meet varied office scenarios and specific customer requirements.

BETTER SERVICE



At LIV, we offer VIP customer service with quick response times to address your needs promptly. Our one-stop service includes purchasing supporting products and arranging delivery when required.

MOBILE APP CONTROL



At LIV, we're committed to bringing comfort to your life. With our application, you can control your office desk and track your health data. This ergonomic app combines various functions of space and health management, allowing you to effortlessly create your smart office. The application is currently available for both Android and Apple iOS operating systems and can be customized according to your preferences at any time.



WHY LIV?

LIV is dedicated to offering high-quality electric height-adjustable desks and ergonomic products. With exceptional design and functionality, we help you work more efficiently and comfortably.



VOICE CONTROL



At LIV, we continuously upgrade and optimize our products by integrating voice recognition systems with our desk control mechanisms. This innovation truly achieves meaningful interaction between people and furniture, enhancing the user experience through intuitive technology.

SUSTAINABLE DEVELOPMENT AND ENVIRONMENTAL PROTECTION



At LIV, we take our corporate social responsibility seriously. This commitment encompasses charity organization work, employee welfare, tax compliance, and environmental stewardship. We pay special attention to environmental protection and your health, ensuring our business practices reflect our values and contribute positively to society.

COMPONENT BASED CUSTOMIZED SOLUTIONS



CUSTOMIZE YOUR COLOR

In addition to the classic black, white, and gray, you can customize desk frames, legs, and feet in almost any specific color.



RAL 9016



RAL 7045



RAL 9005



More Colors



DESIGN YOUR FRAME STRUCTURE

Our production presents you the option of all leg designs from square, to rectangle, to round, and oval tubes, along with our expandable frame with standard or easy assembly options, and our operating system with easily branded handsets. This can be supported further by creating a unique design foot with multiple cable management options.



INNOVATIVE INTELLIGENCE

QUICK INSTALLATION DESIGN

At LIV, we provide efficient and stable lifting products without complicated installation requirements. Our system saves 70% of installation time compared to traditional frame systems, significantly reducing manual desk installation costs.

Option A



Foot Base Connection



Option B

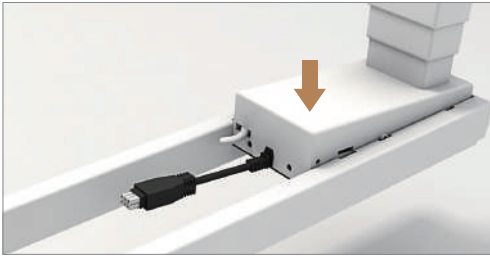

Side Bracket Connection

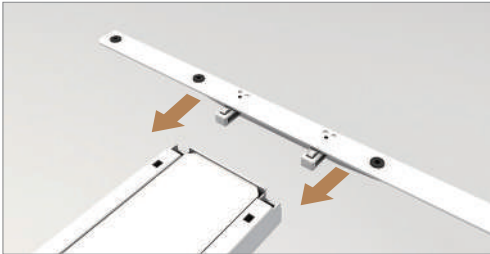

Single Motor Easy Folding Version

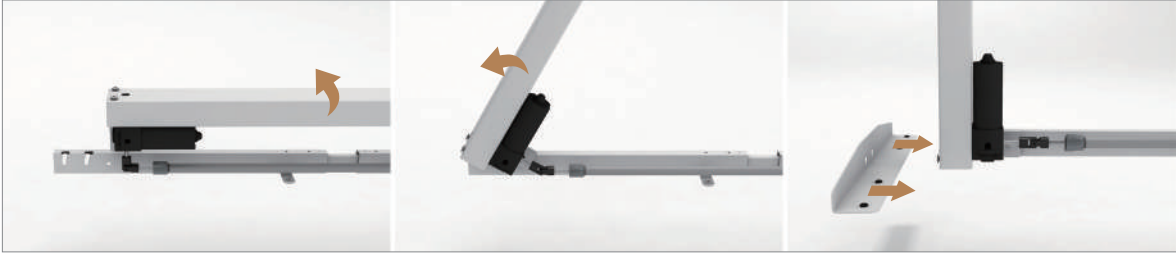

MOBILE APP CONTROL

WIFI control-Update from Bluetooth. With this application, you can control your office desk and track your health data. The application is currently available for both Android and Apple iOS operating systems.

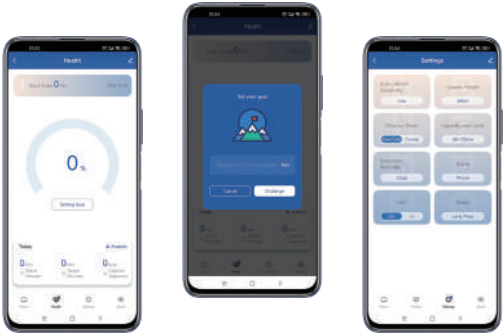

VOICE CONTROL

At LIV, we integrate voice recognition with our desk controls for true human-product interaction. We support multiple voice assistants including Amazon Alexa, Google Assistant, SmartThings, and others to enhance your workspace experience.



New Product Series

Extended Stroke /4-stage

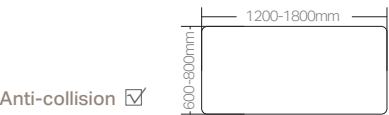

Standard Column

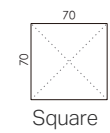

Stroke	Speed
680mm	50mm/s
Width Range	Load Capacity
1010-1750mm	80kg

Height Range
495-1175mm
Voltage
100V-240V

NT33-2BF4A

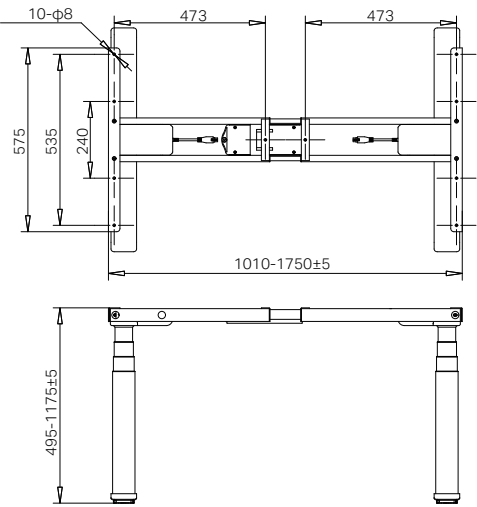

New Product Series

Quick speed-80mm/s / 3-stage

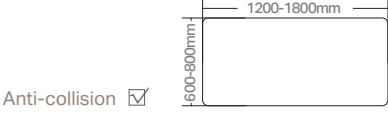

Standard Column

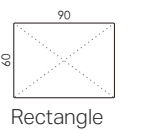
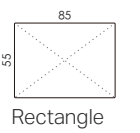
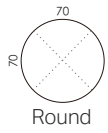
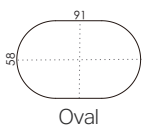
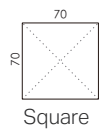

Stroke	Speed	Height Range
650mm	80mm/s	600-1250mm (650-1300mm Oval/Round)
Width Range	Load Capacity	Voltage
1010-1750mm	80kg	100V-240V

NT33-2BF3A

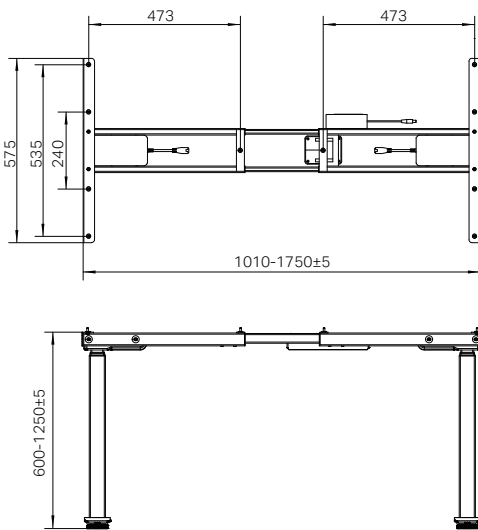

1-leg Series

Single Motor Series / 3-stage

Anti-collision ☒

Height Range(E1)

570-1220mm

Load Capacity

80kg

Height Range(E2)

635-1280mm

Voltage

100V-240V

Height Range(E3)

605-1250mm

Speed

40mm/s

NT33-E1

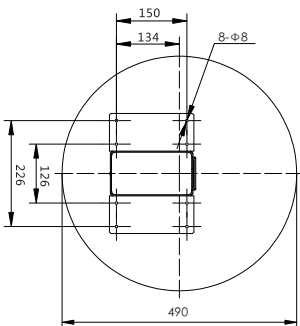

NT33-E2

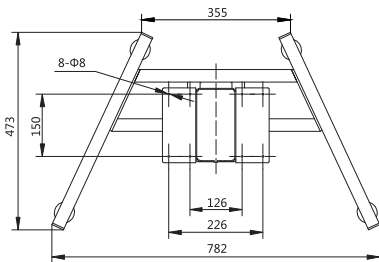

NT33-E3

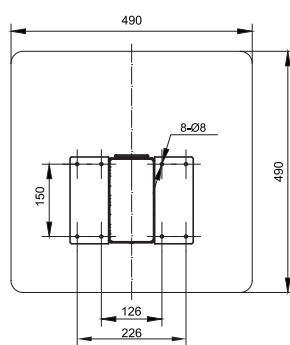

NT33-E1

NT33-E2

NT33-E3

2-legs Series

Dual Motors Series / 2-stage

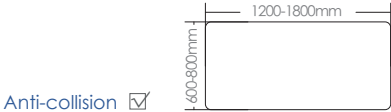

Standard Column

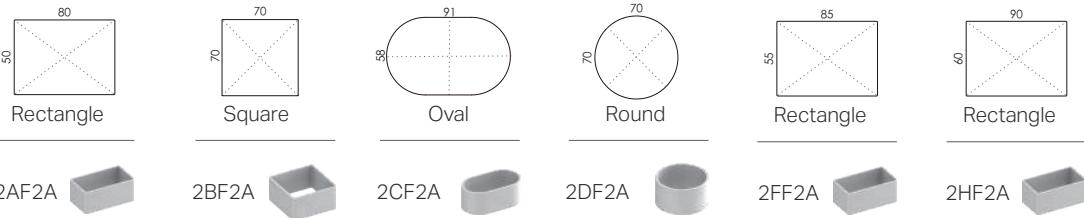

Stroke

500mm

Speed

30mm/s

Height Range

700-1200mm

Width Range

1010-1750mm

Load Capacity

120kg

Voltage

100V-240V

NT33-2CF2A

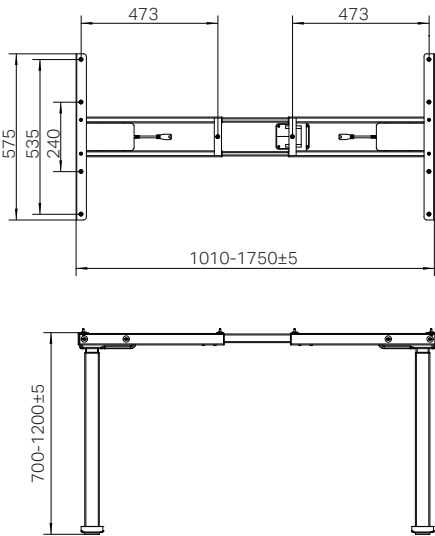

Reversed Column

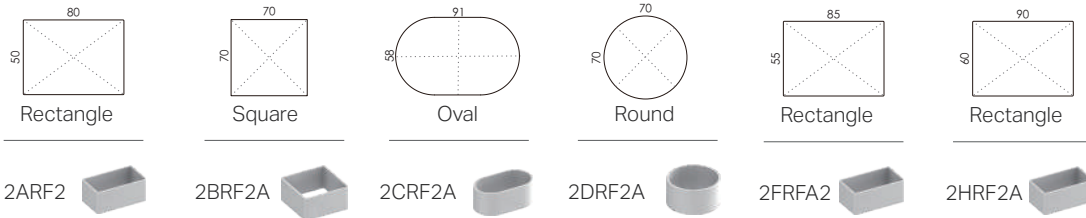

Stroke

500mm

Speed

30mm/s

Height Range

700-1200mm

Width Range

1010-1750mm

Load Capacity

120kg

Voltage

100V-240V

NT33-2ARF2

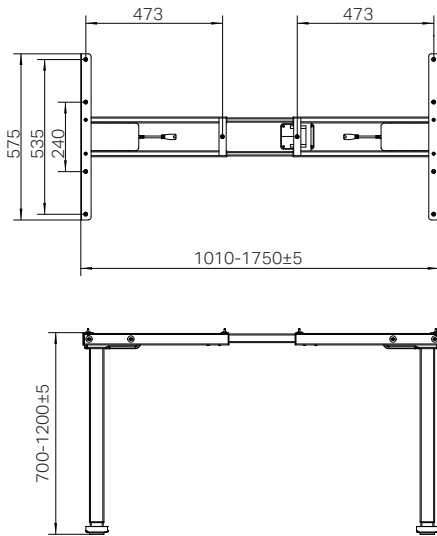



2-legs Series

Dual Motors Series / 3-stage

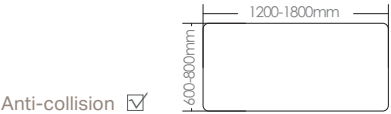

Standard Column

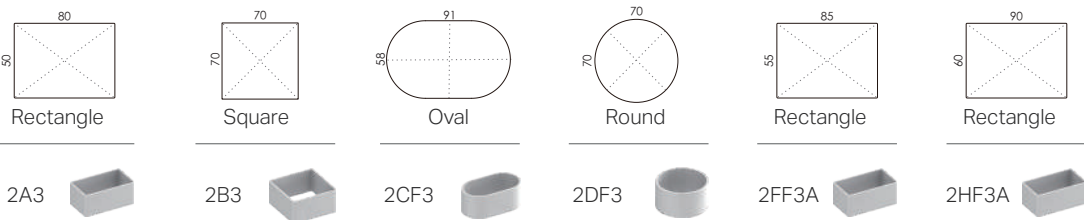

Stroke

650mm

Speed

40mm/s

Height Range

600-1250mm (650-1300mm Oval/Round)

Width Range

1010-1750mm

Load Capacity

120kg

Voltage

100V-240V

NT33-2BF3A

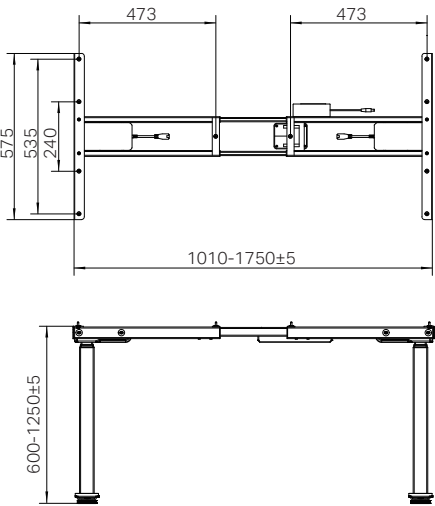

Reversed Column

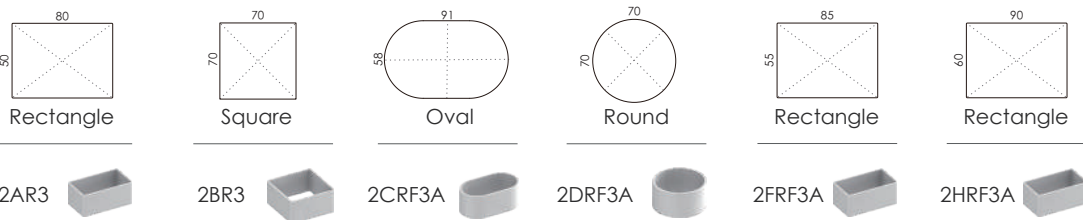

Stroke

650mm

Speed

40mm/s

Height Range

600-1250mm (650-1300mm Oval/Round)

Width Range

1010-1750mm

Load Capacity

120kg

Voltage

100V-240V

NT33-2DRF3A

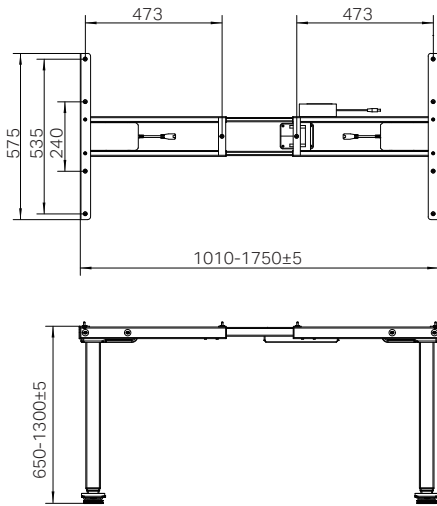

3-legs Series

Three Motors Series / 3-stage

Anti-collision ☒

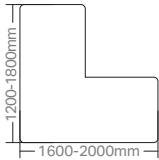

Standard Column

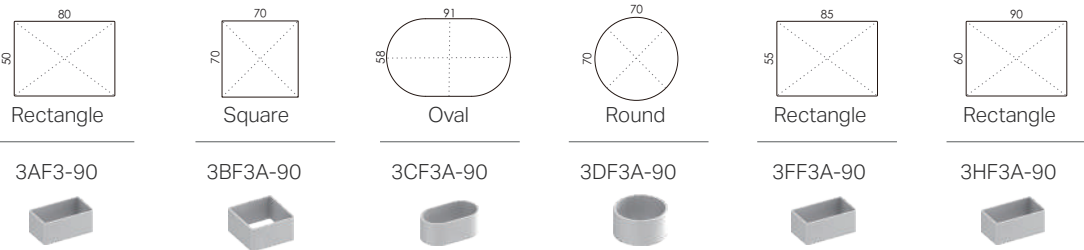

Stroke	Speed	Height Range
650mm	40mm/s	600-1250mm(650-1300mm Oval/Round)
Width Range	Load Capacity	Voltage
1010-1750mm	150kg	100V-240V

NT33-3AF3-90

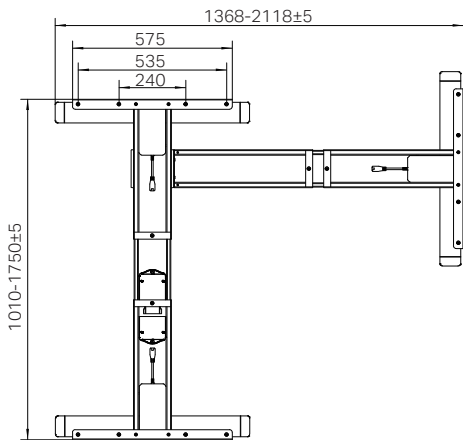

Standard Column

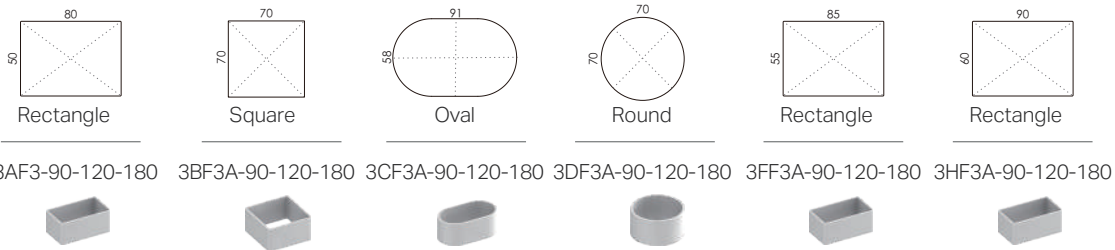

Stroke	Speed	Height Range
650mm	40mm/s	600-1250mm(650-1300mm Oval/Round)
Width Range	Load Capacity	Voltage
1010-1750mm	150kg	100V-240V

NT33-3BF3A-90-120-180

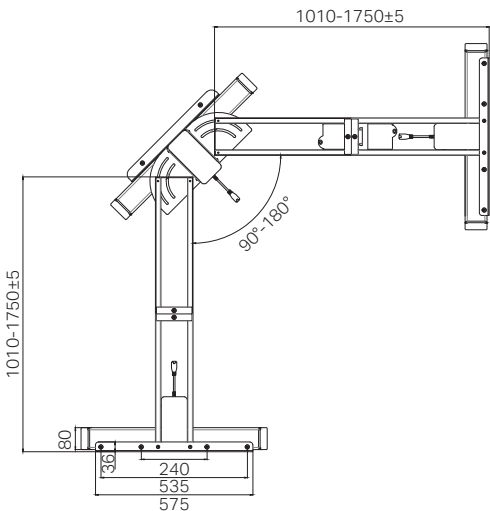



4-legs Series

Four Motors Series / 2-stage

Standard Column

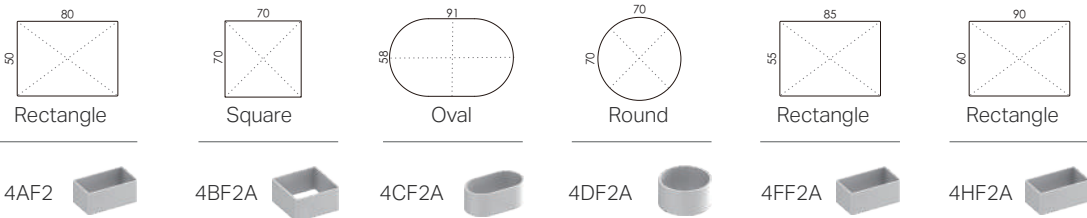

Stroke

500mm

Speed

30mm/s

Height Range

700-1200mm

Width Range

1010-1750mm

Load Capacity

200kg

Voltage

100V-240V

NT33-4DF2A

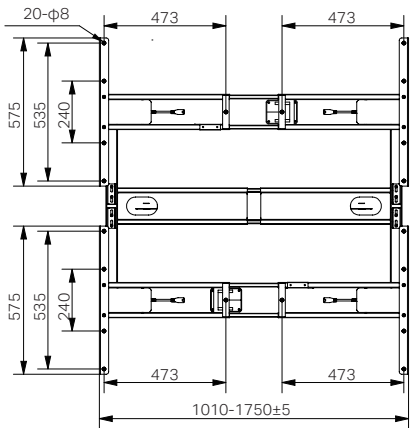

4-legs Series

Four Motors Series / 3-stage

Anti-collision ☒

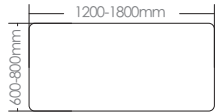

Standard Column

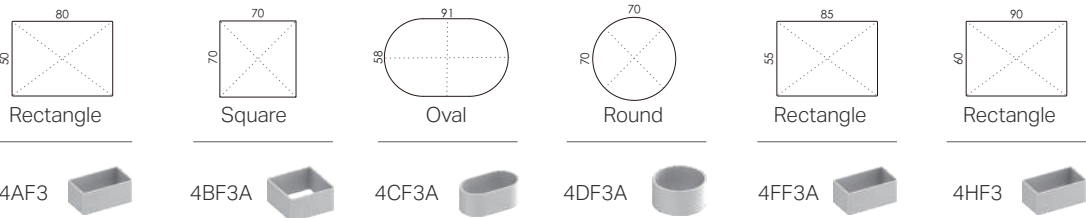

Stroke

650mm

Speed

40mm/s

Height Range

600-1250mm (650-1300mm Oval/Round)

Width Range

1010-1750mm

Load Capacity

200kg

Voltage

100V-240V

NT33-4BF3A

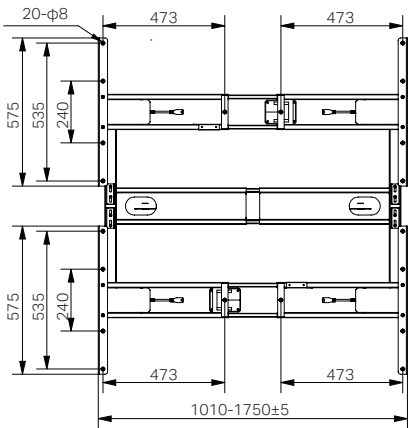

4-legs Series

Four Motors Series / Dining table / 3-stage

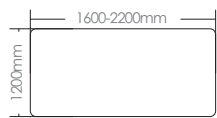

Standard Column

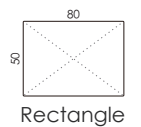

Stroke

650mm

Speed

40mm/s

Height Range

595-1245mm

Width Range

1636-2406mm

Load Capacity

200kg

Voltage

100V-240V

NT33-Z4W

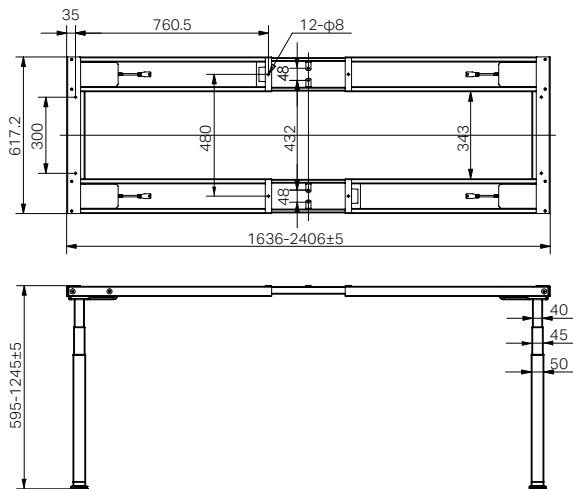

4-legs Series

Two Motors Series / Dining table / 2-stage

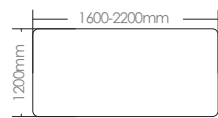

Reversed Column

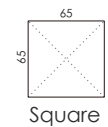

Stroke

440mm

Speed

20mm/s

Height Range

710-1150mm

Width Range

1100-1800mm

Load Capacity

100kg

Voltage

100V-240V

NT33-CZ

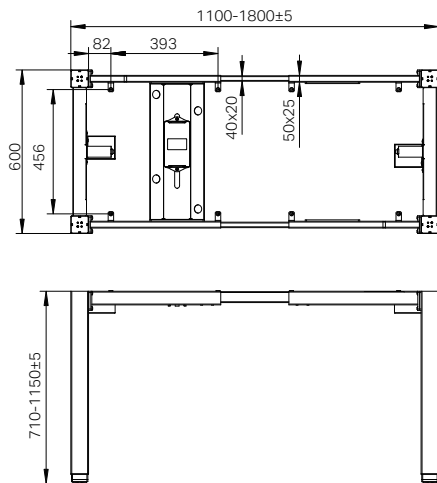
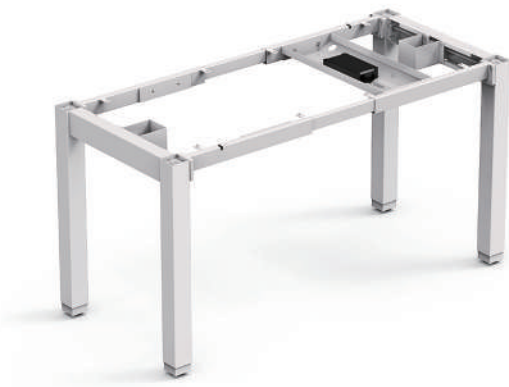

Economical Series

Single Motor Series / 2-stage

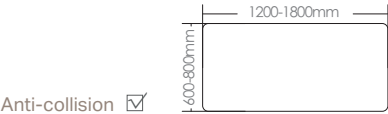

Stroke	Height Range
440mm	710-1150mm
Width Range	Load Capacity
1105mm	80kg
Speed	Voltage
20mm/s	100V-240V

Stroke	Height Range
440mm	700-1140mm
Width Range	Load Capacity
990-1400mm	70kg
Speed	Voltage
20mm/s	100V-240V

Stroke	Height Range
440mm	700-1140mm
Width Range	Load Capacity
850-1300mm	80kg
Speed	Voltage
20mm/s	100V-240V

Stroke	Height Range
440mm	700-1140mm
Width Range	Load Capacity
934-1254mm	70kg
Speed	Voltage
15mm/s	100V-240V

NT33-2S2-2

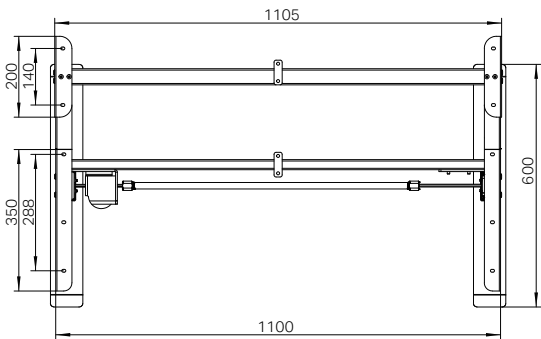

NT33-2S2G

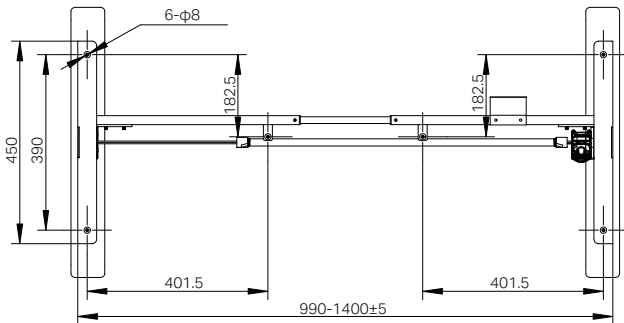

NT33-SR2B (ADJUSTABLE WIDTH)

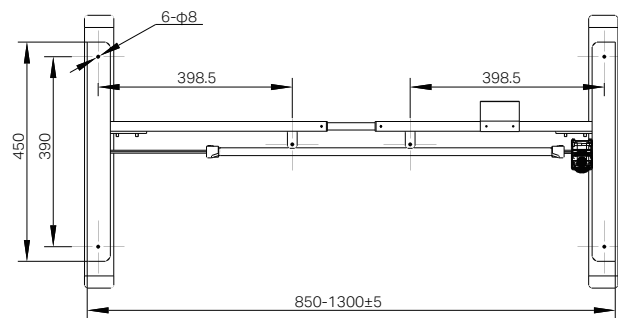

NT33-SR2D (ADJUSTABLE WIDTH)

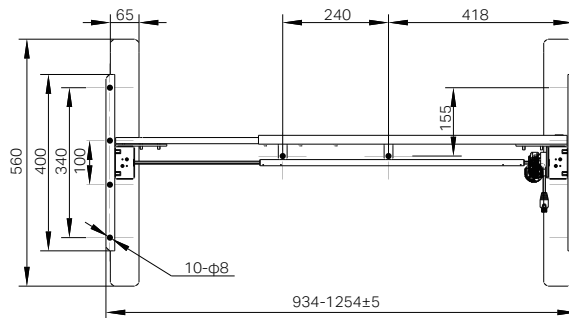

Manual Series

Hand Crank / 2-stage

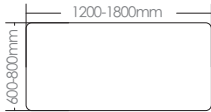

Stroke

450mm

Speed

12 mm/circl

Height Range

710-1160mm

Width Range

986mm /1000-1400mm

Load Capacity

80kg

NT33-2M2B (FIXED WIDTH)

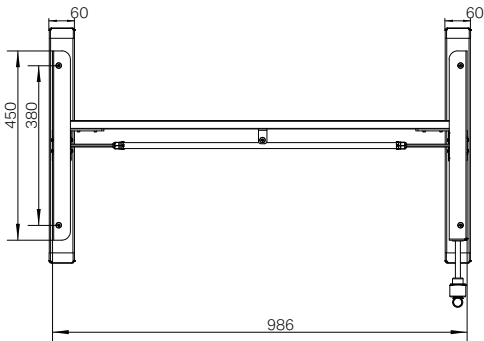

NT33-2M2B (ADJUSTABLE WIDTH)

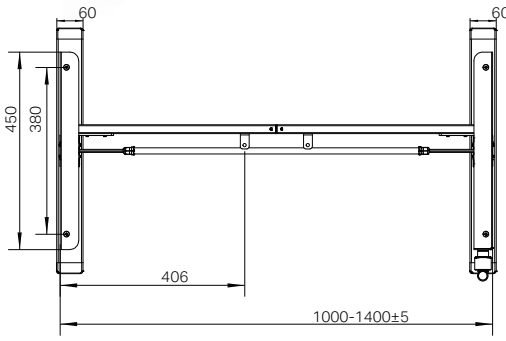

Home Office Series

Glass Table Series / 2-stage



Stroke

500mm

Height Range

710-1210mm

Speed

30mm/s

Top Size

1200x600mm

Load Capacity

100kg

Voltage

100V-240V

NT33-E4

🔌 Type-A*1 (18W)

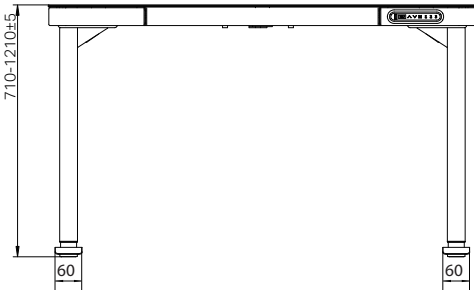

NT33-E4Pro

🔌 Wireless Charging*1 (10W)
🔌 Type-C*1 (18W)
🔌 Type-A*2 (18W)

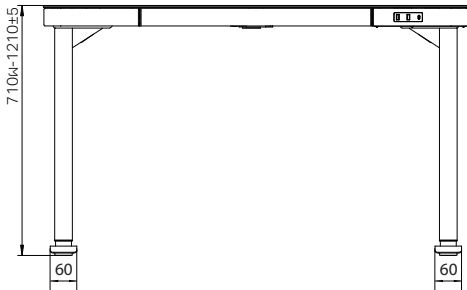



Home Office Series

Wooden Table Series / 2-stage

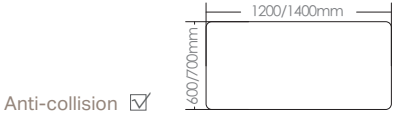

Stroke	Height Range	Speed
500mm	710-1210mm	30mm/s
Top Size	Load Capacity	Voltage
1200x600mm/ 1400x700mm	100kg	100V-240V

NT33-E4(A)

- Type-C*2 (18W)
- Type-A*1 (18W)

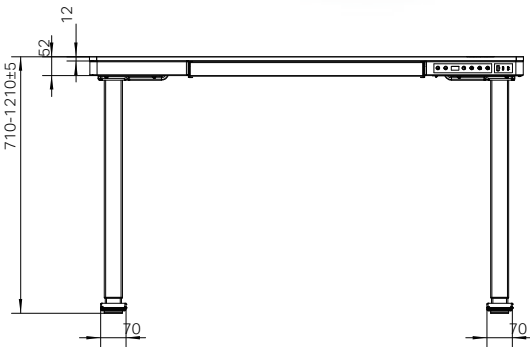

NT33-E4(A)Pro

- Wireless Charging*1 (10W)
- Type-C*1 (18W)
- Type-A*2 (18W)

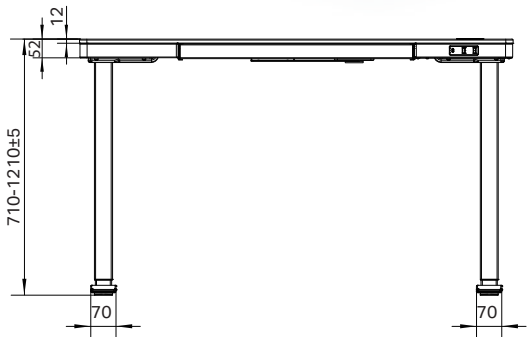

Lift Columns

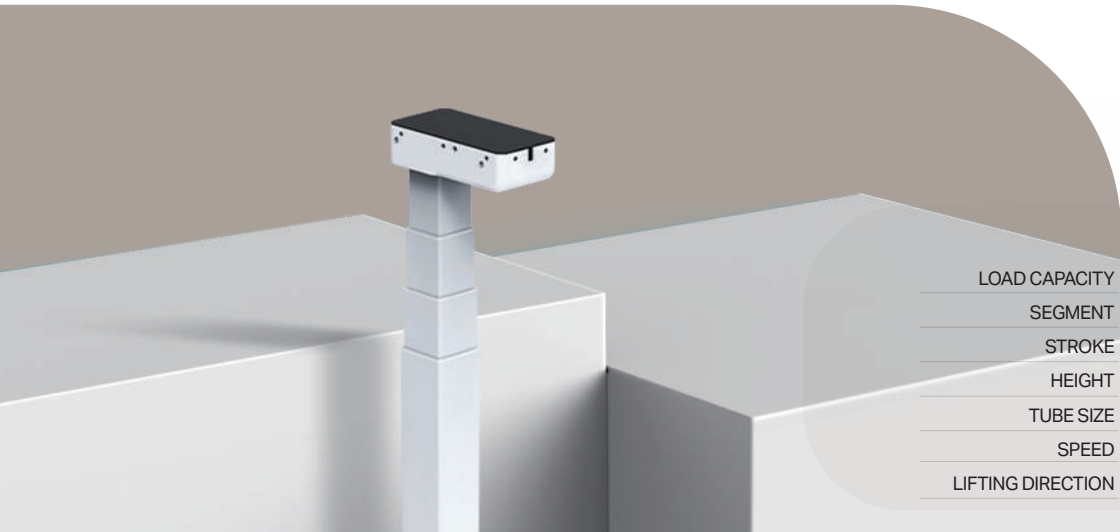

LOAD CAPACITY
SEGMENT
STROKE
HEIGHT
TUBE SIZE
SPEED
LIFTING DIRECTION

BF4A
50KG
4 Stage
680mm
460-1140mm
55*55-60*60-65*65-70*70mm
50mm/s
Standard

LOAD CAPACITY
SEGMENT
STROKE
HEIGHT
TUBE SIZE
SPEED
LIFTING DIRECTION

BF2A
80KG
2 Stage
500mm
665-1165mm
60*60-70*70mm
30mm/s
Standard



CF2A
80KG
2 Stage
500mm
665-1165mm
50*83-58*91mm
30mm/s
Standard



DF2A
80KG
2 Stage
500mm
665-1165mm
φ63.5-φ70mm
30mm/s
Standard



LOAD CAPACITY
SEGMENT
STROKE
HEIGHT
TUBE SIZE
SPEED
LIFTING DIRECTION

AF2A
80KG
2 Stage
500mm
665-1165mm
45*75-50*80mm
30mm/s
Standard



AF3
80KG
3 Stage
650mm
565-1215mm
40*70-45*75-50*80mm
40mm/s
Standard



BF3A
80KG
3 Stage
650mm
565-1215mm
50*50-60*60-70*70mm
40mm/s
Standard



LOAD CAPACITY
SEGMENT
STROKE
HEIGHT
TUBE SIZE
SPEED
LIFTING DIRECTION

BF3A PRO
80KG
3 Stage
650mm
565-1215mm
50*50-60*60-70*70mm
80mm/s NEW
Standard



CF3A
80KG
3 Stage
650mm
600-1250mm
42*75-50*83-58*91mm
40mm/s
Standard



DF3A
80KG
3 Stage
650mm
600-1250mm
φ57-φ63.5-φ70mm
40mm/s
Standard



LOAD CAPACITY
SEGMENT
STROKE
HEIGHT
TUBE SIZE
SPEED
LIFTING DIRECTION

ARF2A
80KG
2 Stage
500mm
665-1165mm
45*75-50*80mm
30mm/s
Reverse



ARF3
80KG
3 Stage
650mm
565-1215mm
40*70-45*75-50*80mm
40mm/s
Reverse



BRF3A
80KG
3 Stage
650mm
565-1215mm
50*50-60*60-70*70mm
40mm/s
Reverse



LOAD CAPACITY
SEGMENT
STROKE
HEIGHT
TUBE SIZE
SPEED
LIFTING DIRECTION

FF3A
80KG
3 Stage
650mm
565-1215mm
45*75-50*80-55*85mm
40mm/s
Standard



HF2A
80KG
2 Stage
500mm
665-1165mm
55*85-60*90mm
30mm/s
Standard



HF3A
80KG
3 Stage
650mm
565-1215mm
50*80-55*85-60*90mm
40mm/s
Standard





LIV offers a variety of easily branded Handsets in different designs with a wide range of functions.

Define your requirement, choose your design, and soon you will be moving further with your new table.

Handsets

Choose The Best Handset Options For Your Frame!

NT33-HV ●

- OLED Screen
- UP DOWN Paddle
- 2 Memory Preset
- Child Lock
- Anti-collision
- One Touch Adjustment
- Type C-quick charge
- LED Light (Green/Orange/white)
- Time Reminder
- Multiple languages available ENG,DE,FR,ES,IT.
- Logo on start up



NT33-BHR ●

- Handset Integrated
- Digital LED Screen
- Six Button
- 3 Memory Preset
- Child Lock
- Anti-collision
- One Touch Adjustment
- USB Port



NT33-BHP ●

- Handset Integrated
- Digital LED Screen
- Six Button
- 3 Memory Preset
- Child Lock
- Anti-collision
- One Touch Adjustment
- USB Port



NT33-BHH ○●●

- Handset Integrated
- Digital LED Screen
- Six Button
- 3 Memory Preset
- Child Lock
- Anti-collision
- One Touch Adjustment



NT33-BHG ○●●

- Handset Integrated
- Digital LED Screen
- Eight Button
- 4 Memory Preset
- Child Lock
- Time Reminder
- Anti-collision
- One Touch Adjustment
- Type C-quick charge



NT33-H1B ○●●

- Digital LED Screen
- Two Button-UP Down
- Anti-collision



NT33-HF ●

- UP DOWN Button
- Anti-collision



NT33-HB ●

- Digital LED Screen
- Seven Button
- 4 Memory Preset
- Child Lock
- Anti-collision
- One Touch Adjustment
- USB+Type C-quick charge



NT33-HE ●

- Digital LED Screen
- Seven Button
- 4 Memory Preset
- Child Lock
- Anti-collision
- One Touch Adjustment
- USB Port



NT33-HH ●

- Digital LED Screen
- Seven Button
- 3 Memory Preset
- Child Lock
- Anti-collision
- One Touch Adjustment
- USB Port
- Recessed Into Table Top



Reminder

NT33-HK ●

- Digital LED Screen
- Seven Button
- 3 Memory Preset
- Child Lock
- Anti-collision
- One Touch Adjustment
- Time Reminder
- USB Port



Reminder

NT33-HZ ○●

- Digital LED Screen
- Seven Button
- 3 Memory Preset
- Child Lock
- Anti-collision
- One Touch Adjustment
- Time Reminder
- USB+Type C-quick charge



NT33-HU ○●●●

- Digital LED Screen
- Six Button
- 3 Memory Preset
- Child Lock
- Anti-collision
- One Touch Adjustment
- Type C-quick charge



Reminder

NT33-HW ○●●

- Digital LED Screen
- Eight Button
- 4 Memory Preset
- Child Lock
- Anti-collision
- One Touch Adjustment
- Type C-quick charge
- Time Reminder



NT33-H1D ●

- Digital LED Screen
- Five Button
- 2 Memory Preset
- Child Lock
- Anti-collision
- One Touch Adjustment
- Type C-quick charge
- LED Light Background

Feet

FA03B

DIMENSION	700x75x20mm
PLATE THICKNESS	2.5mm/2.5mm
FIT TUBE	Rectangle(80*50)

Control Box

NT33-BK

- 2 legs supported
- Energy saving during non-use
- Low standby power consumption: <0.3w
- Input: 100-240V 50-60Hz,5A
- Output: 32Vdc,each 110VA,total 220VA
- Duty cycle: 2min ON/18min OFF
- Anti-collision protection sensitivity function
- Worldwide industry certified

		
FA22	FB18	FC04
DIMENSION	600x750x18mm	700x80x18mm
PLATE THICKNESS	2.5mm/2.0mm	2.5mm/3.0mm
FIT TUBE	Rectangle(80*50)	Square
		
FR46	FA85	
DIMENSION	560x65x17mm	700x75x22mm
PLATE THICKNESS	2.0mm/2.0mm	2.5mm/2.0mm
FIT TUBE	Rectangle(80*50)	Rectangle(85*55,90*60)

				
FR30	FA55	FA67	FC06	FD04
DIMENSION	560x60x20mm	560x60x20mm	60x70x20mm	700x85x20mm
PLATE THICKNESS	2.0mm	2.0mm	2.0mm	3.0mm/3.0mm
FIT TUBE	Rectangle(80*50)	Rectangle(80*50)	Oval	Round

			
LJK-A	LJK-H/F	LJK-B	LJK-D
Rectangle (80*50)	Rectangle (85*55,90*60)	Square (70*70)	Round (70*70)
			
JLD	JLE	HLA	HLD
φ50 M8*14	φ65 M8*14	φ40 M8*15	φ50 M8*15



NT33-BA

- 2 legs supported
- Energy saving during non-use
- Low standby power consumption: <0.3w
- Input: 100-240V 50-60Hz,5A
- Output: 32Vdc,each 110VA, total 220VA
- Duty cycle: 2min ON/18min OFF
- Anti-collision protection sensitivity function
- Worldwide industry certified



NT33-BB

- 1 legs supported
- Energy saving during non-use
- Low standby power consumption: <0.3w
- Input: 100-240V 50-60Hz,2.5A
- Output: 24Vdc,each 100VA
- Duty cycle: 2min ON/18min OFF
- Anti-collision protection sensitivity function
- Worldwide industry certified



NT33-BC

- 3 legs supported
- Energy saving during non-use
- Low standby power consumption: <0.3w
- Input: 100-240V 50-60Hz,10.5A
- Output: 30Vdc,each 3.5A, total 10.5A
- Duty cycle: 2min ON/18min OFF
- Anti-collision protection sensitivity function
- Worldwide industry certified



NT33-BD

- 2 legs supported
- Energy saving during non-use
- Low standby power consumption: <0.3w
- Input: 28-32V
- Output: 18-26V
- Duty cycle: 2min ON/18min OFF
- Anti-collision protection sensitivity function
- Worldwide industry certified



NT33-BO

- 4 legs supported
- Energy saving during non-use
- Low standby power consumption: <0.3w
- Input: 220-240VAC 50-60Hz,5A
- Output: 30Vdc,each 3A,total 12A
- Duty cycle: 2min ON/18min OFF
- Anti-collision protection sensitivity function
- Worldwide industry certified

Environmental sustainability

Reduce Desk Consumption

One desk can concurrently satisfy every family member or colleague with different body height, desk with metal frame can use for longer years.



Standby Power < 0.3W

The most important part of an height adjustable desk is the control box, and its standby power is the key to reduce energy consumption of entire system.



Environmental Protection Certificate

We have passed RoHs, REACH, WEEE certificate. Use eco-friendly materials, care for the environment.



Continuous Product Upgrade

We always insist on developing eco-friendly products with less environmental wastes.



Digital Management

Use ERP system and other digital tools to reduce waste like paper, increase efficiency.



Permanent Magnet Air Compressor

Save electric energy 33 thousand kwh per year.



Lighting Energy Saving

Use energy-efficient light to reduce electric energy.



Integration Of Informatization And Industrialization

Integration of Informatization and Industrialization-Management system certificate, adjust our industrial structure and develop new emerging industries such as High-tech enterprises.



ISO14001 and Clean Production Report

We have passed Environmental Management System Certificate and Clean Production Report every year to prove that we insist on sustainability of environment.



Social sustainability

Employee Care

At LIV, we provide comprehensive employee benefits beyond compulsory insurance, including accident insurance, health insurance, performance bonuses, and paid annual leave.

We're committed to developing our team through inclusive training programs that enhance education and skill capabilities.



Social Responsibility

At LIV, we collaborate with partners who share our commitment to giving back to society. Our manufacturing partners actively support underprivileged families and provide assistance during crises like the Wuhan epidemic and Gansu earthquake, reflecting the values of social responsibility that we embrace throughout our business ecosystem.



BSCI And ISO45001

We have passed BSCI and Iso45001 to protect employers' health and rights.



ISO14604 Certificate

At LIV, we partner with manufacturers who continuously monitor greenhouse gas (GHG) emissions in their operations. Our production partners share our environmental commitment and strive to reduce emissions through improved manufacturing processes and enhanced product performance. Together, we're working toward the ambitious goals of "carbon neutrality" or "zero carbon emissions" in the future.

